

PROFIL: Ny røyrgate

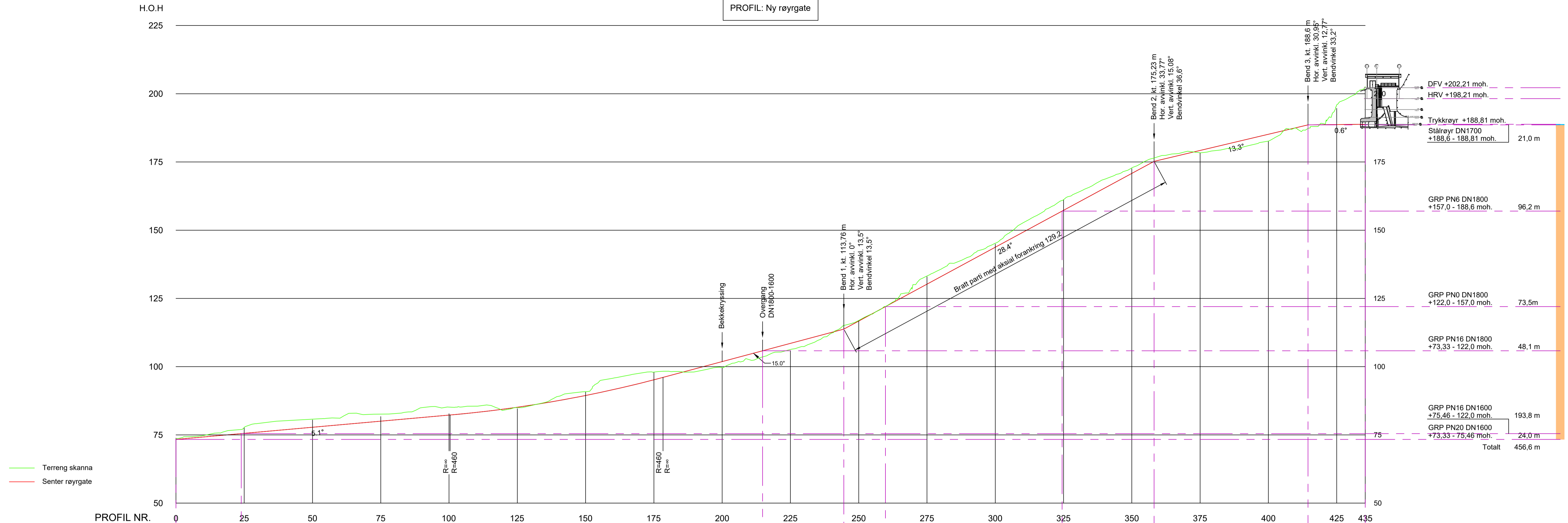

Terreng skanna  
Senter røyrgate

PROFIL NR. 0 25 50 75 100 125 150 175 200 225 250 275 300 325 350 375 400 425 435

Overdekning over topp røyr	Minimum 1 m overdekning	
Stedlige masser 0-40 mm	Pukk 8-32 mm	

HOR.KURVATUR RØYR	VERT. KURVATUR RØYR
L=358.14	R=460
L=56.35	27%
L=20.98	54%
	24%
	1%

HØGDE SENTER RØYR	TERRENG HØGDE SKANNA
74.4	73.8
74.2	74.2
74.7	74.7
75.1	75.1
75.6	75.6
76.0	76.0
76.5	76.5
77.3	77.3
77.8	77.8
78.2	78.2
79.1	79.1
79.6	79.6
80.0	80.0
80.5	80.5
80.9	80.9
81.4	81.4
81.8	81.8
82.2	82.2
82.7	82.7
83.2	83.2
83.7	83.7
83.8	83.8
84.5	84.5
85.1	85.1
85.7	85.7
86.7	86.7
87.6	87.6
88.5	88.5
89.5	89.5
90.5	90.5
91.6	91.6
92.7	92.7
93.9	93.9
95.2	95.2
96.5	96.5
97.8	97.8
99.2	99.2
100.5	100.5
101.9	101.9
103.2	103.2
104.5	104.5
105.9	105.9
107.2	107.2
108.5	108.5
109.9	109.9
111.2	111.2
112.5	112.5
113.8	113.8
115.1	115.1
116.4	116.4
117.7	117.7
119.0	119.0
120.3	120.3
121.6	121.6
122.9	122.9
124.2	124.2
125.5	125.5
126.8	126.8
128.1	128.1
129.4	129.4
130.7	130.7
132.0	132.0
133.3	133.3
134.6	134.6
135.9	135.9
137.2	137.2
138.5	138.5
139.8	139.8
141.1	141.1
142.4	142.4
143.7	143.7
145.0	145.0
146.3	146.3
147.6	147.6
148.9	148.9
150.2	150.2
151.5	151.5
152.8	152.8
154.1	154.1
155.4	155.4
156.7	156.7
158.0	158.0
159.3	159.3
160.6	160.6
161.9	161.9
163.2	163.2
164.5	164.5
165.8	165.8
167.1	167.1
168.4	168.4
169.7	169.7
171.0	171.0
172.3	172.3
173.6	173.6
174.9	174.9
176.2	176.2
177.5	177.5
178.8	178.8
180.1	180.1
181.4	181.4
182.7	182.7
184.0	184.0
185.3	185.3
186.6	186.6
187.9	187.9
189.2	189.2
190.5	190.5
191.8	191.8
193.1	193.1
194.4	194.4
195.7	195.7
197.0	197.0
198.3	198.3
199.6	199.6
200.9	200.9

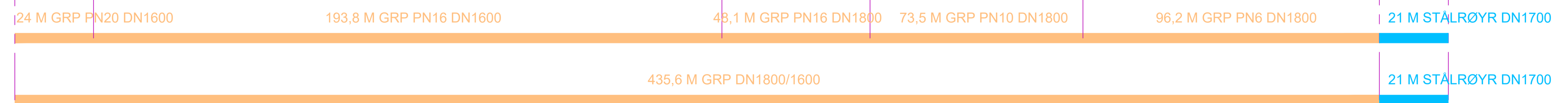

Rev.	Revisjon/gjort	Uttatt	Kontroll	Dato
1	Som bygget ledd			03.04.2023
2	Arbeidsledning			
3	Konstruksjon			
4	Målestokning			
5	Formell			
6	Formell			

Sunnhordland Kraftlag AS  
Driftsvegvev Hålandsvatnet

Ny røyrgate  
Vertikalprofil

110  
Revisjon